



ROSETTI MARINO
Group of Companies

AHT

MULTIFUNCTIONAL ANCHOR HANDLING TUG, SUPPLY SALVAGE SERVICE VESSEL - UT 514 L

Name of Vessel

C78 - CARLO MAGNO (delivered 2006)
C92 - CARLO MARTELLO (delivered 2009)

Type of Vessel

Multifunctional Anchor Handling, Supply Salvage, Service Vessel

Class notation

R.I.Na: C \boxtimes AUT-UMS; FIRE FIGHTING SHIP 1; WATERSPRAY SYSTEM;
TUG; SUPPLY VESSEL; UNRESTRICTED NAVIGATION; SALVAGE TUG

Design

ROLLS-ROYCE MARINE

Builder

ROSETTI MARINO S.p.A.

Owner and operator

AUGUSTEA IMPRESE MARITTIME E DI SALVATAGGIO S.p.A.



AHT | UT 514 L

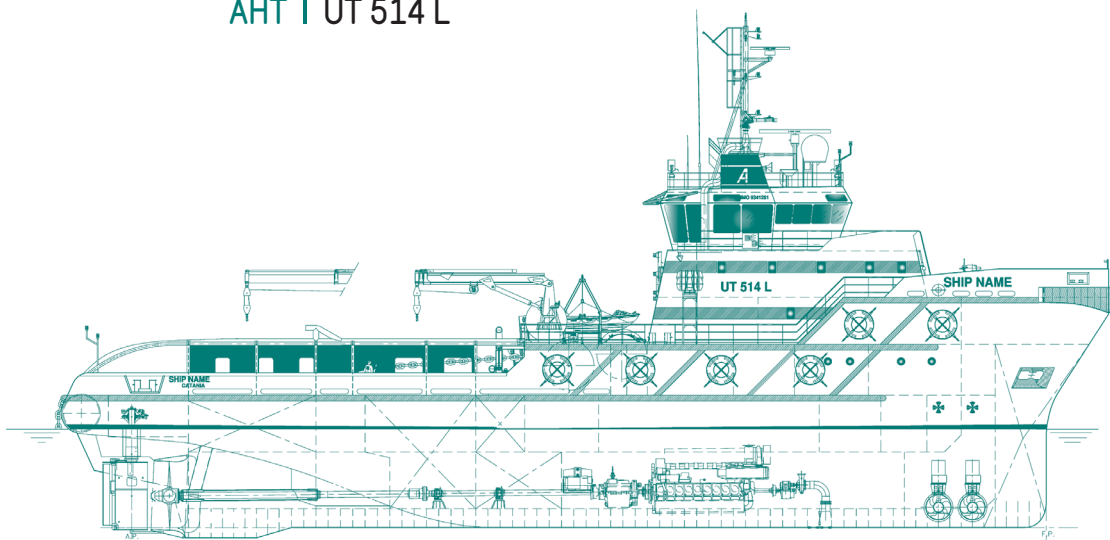

PROFILE

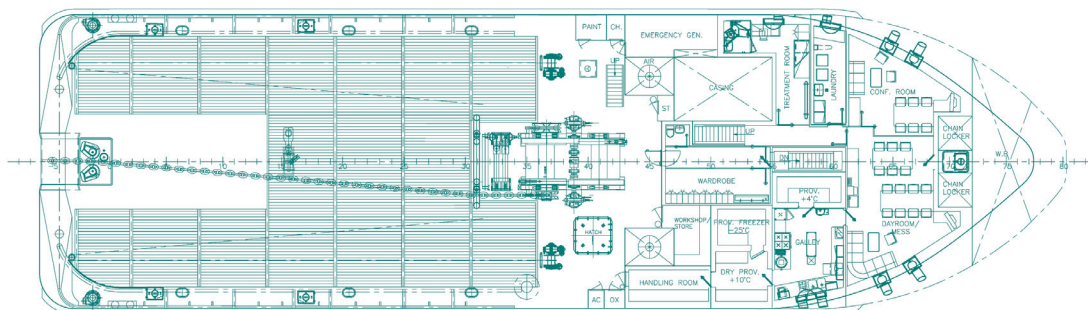

MAIN DECK

MAIN PARTICULARS		MACHINERY / PROPULSION	
Length overall	55.40 m	Main engines - Wartsila 8L32 HFO	2 x 4000 kW at 750 rpm
Breadth, moulded	15.50 m	Shaft Generators - Marelli MJR 400 LB4	2 x 1250 kVA at 1800 rpm
Length between perpendiculars	48.40 m	Diesel Generators - Volvo Penta D12 AUX	2 x 438 kVA at 1800 rpm
Design draught	5.20 m	Harbour Generator - Volvo Penta D5A	1 x 85 kVA at 1800 rpm
Max operation draught	5.80 m	Bow thrusters - RRM electrical drive type TT1300 DPN CP	2 x 350 kW
Scantling draught as Tug (0,9D)	6.30 m	Propellers	2 x CP with nozzles - 86 P1/4T - dia. 3600 mm
Depth	7.00 m	Rudders	2 x high flap SR662 - FCPX2
Dead weight at max operation draught 5.8 m	1600 t	Fire-Fighting system	Fi-Fi 1
Gross tonnage	1733 GT	Deck Crane	2.5 at 16 m
Deck cargo/ Deck area	500 t / 300 m ²		
Accommodation	24 persons		
BOILERS, STEAM & GAS GENERATORS		TANK CAPACITIES	
MGO fired heater	2 x 300 kW heating capacity 14 m ³ /h thermal oil flow	Fuel Oil, incl. Service tanks (Marine Gas Oil MGO)	250 m ³
Exhaust gas economiser	2 x 300 kW heating capacity 14 m ³ /h thermal oil flow	Water Ballast	140 m ³
		Fresh Water	150 m ³
		HFO, incl. settling and service tanks	1200 m ³
PERFORMANCES			
Bollard pull	155 t	Max speed	15.00 knots



Rosetti Marino Headquarters
 Via Trieste, 230 - 48122 Ravenna - Italy
 tel. +39 0544 878 111 - fax +39 0544 878 188
 e-mail: rosetti@rosetti.it - www.rosetti.it

AHT

ANCHOR HANDLING TUG, SALVAGE VESSEL - AHT 5015

Name of Vessel

C99 - KAMARINA (delivered 2010)

C100 - ERACLEA (delivered 2010)

Type of Vessel

Anchor Handling Tug, Salvage Vessel

Class notation

R.I.Na: C~~9~~; ~~9~~AUT-UMS; TUG; SALVAGE TUG;
SUPPLY VESSEL; UNRESTRICTED NAVIGATION

Design

INTERNATIONAL ENGINEERING AND DESIGN

Builder

ROSETTI MARINO S.p.A.

Owner and operator

AUGUSTEA IMPRESE MARITTIME E DI SALVATAGGIO S.p.A.



AHT | AHT 5015

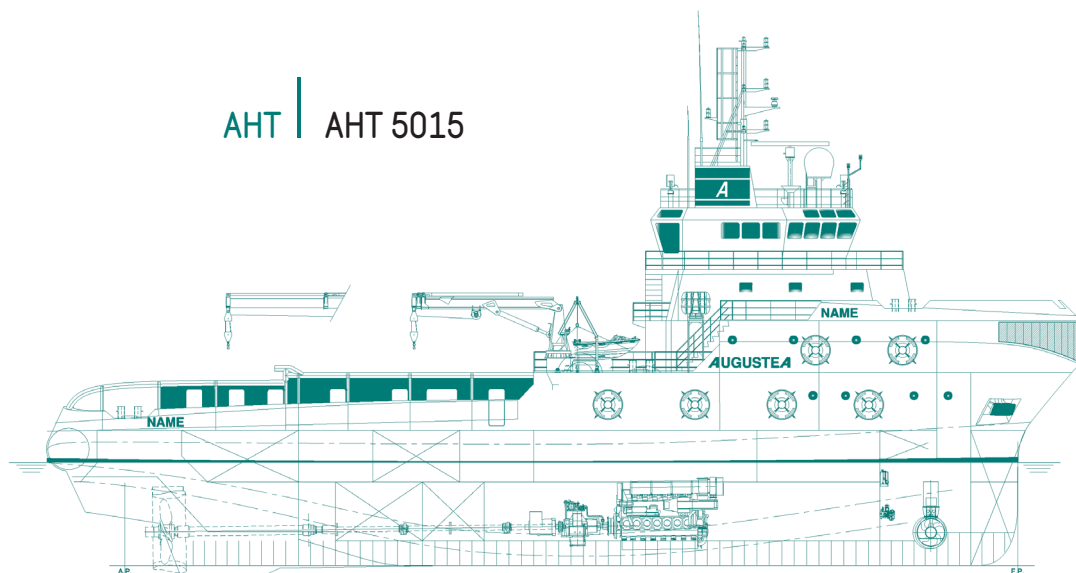

PROFILE

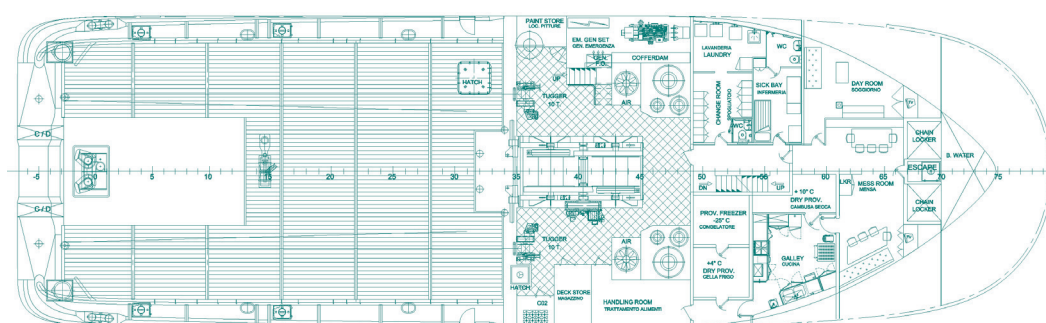

MAIN DECK

MAIN PARTICULARS

Length overall	50.00 m
Breadth, moulded	15.00 m
Length between perpendiculars	43.23 m
Maximum draught	5.00 m
Depth	6.55 m
Dead weight at max. operation draught	1200 t
Gross tonnage	1397 GT
Deck cargo / Deck area	250 m ²
Accommodation	18 persons

PERFORMANCES

Bollard Pull	100 t
Max speed	13.00 knots
Fuel consumption:	
Running free	33 t/day max speed
	11 t/day service speed

MACHINERY / PROPULSION

Main engines - Wartsila 6L32 HFO	2 x 3000 kW at 750 rpm
Shaft Generators - Marelli MJR 400 LB4	2 x 800 kW at 1800 rpm
Diesel Generators Volvo Penta D9AMG 215	2 x 265 kW/269 kVA at 1800 rpm 440V - 60Hz
Emergency Generator - Perkins	1 x 244 kW/200 kVA at 1800 rpm - 440V - 60Hz
Bow thrusters LIPS CT125	400 kW
CP Propellers	2 x LIPS 4D755 dia 3.2 m in nozzle
Rudders - RRM Tenfjord	High lift flap
Fire-Fighting system	Fi-Fi 1

TANK CAPACITIES

Fuel Oil (MGO)	145 m ³
Water Ballast	258 m ³
Fresh Water	109 m ³
HFO	1050 m ³

BOILERS, STEAM & GAS GENERATORS

MGO fired heater	2 x 300 kW
Exhaust gas economiser	2 x 300 kW



Rosetti Marino Headquarters
Via Trieste, 230 - 48122 Ravenna - Italy
tel. +39 0544 878 111 - fax +39 0544 878 188
e-mail: rosetti@rosetti.it - www.rosetti.it



ROSETTI MARINO
Group of Companies

AHT

MULTIFUNCTIONAL ANCHOR HANDLING TUG, SALVAGE VESSEL - AHT 5215

Name of Vessel

C106 - ALMISAN (delivered 2011)

Type of Vessel

Multifunctional Anchor Handling Tug, Salvage Vessel

Class notation

R.I.Na: C~~2~~ AUT-UMS; AUT PORT; FIRE FIGHTING SHIP 2; TUG;
DYNAPOS AM-R; OIL RECOVERY SHIP; INWATERSURVEY;
UNRESTRICTED NAVIGATION; SALVAGE TUG

Design

INTERNATIONAL ENGINEERING AND DESIGN

Builder

ROSETTI MARINO S.p.A.

Owner and operator

AUGUSTA OFFSHORE S.p.A.



AHT | AHT 5215

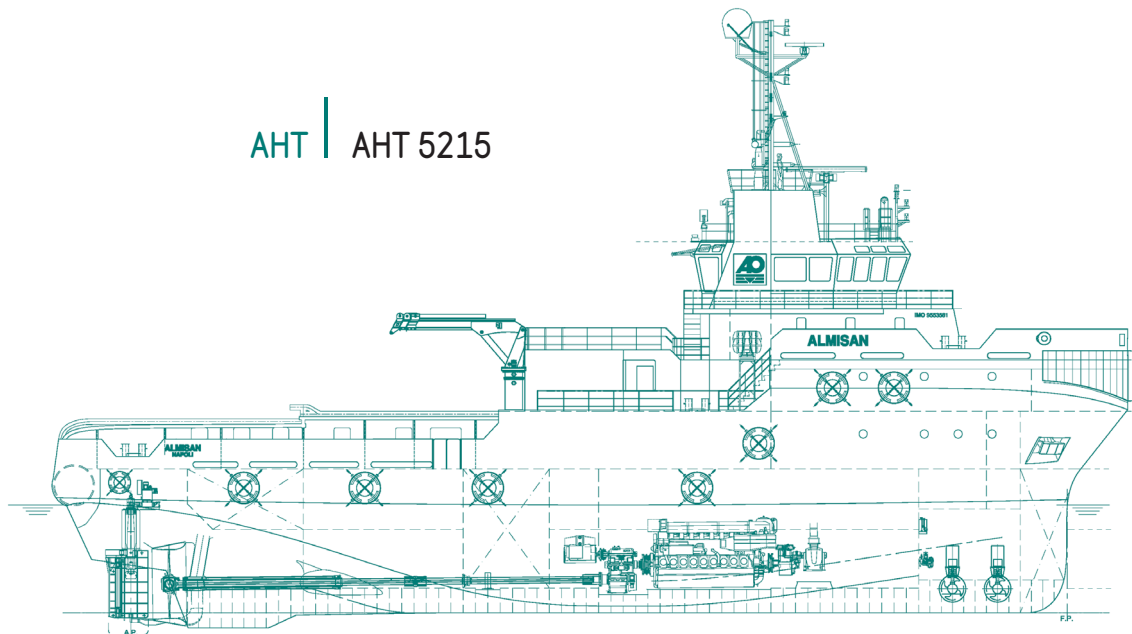

PROFILE

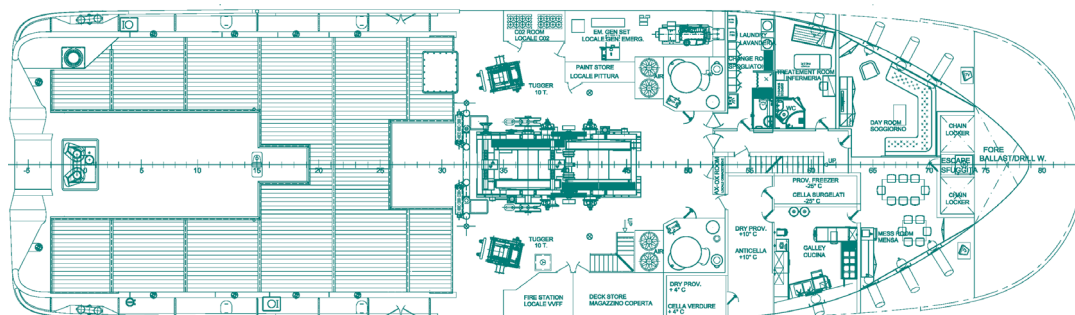

MAIN DECK

MAIN PARTICULARS	
Length overall	52.40 m
Breadth, moulded	15.00 m
Length between perpendiculars	45.63 m
Design draught	5.65 m
Depth	7.00 m
Dead weight	1264 t
Gross tonnage	1659 GT
Deck cargo / Deck area	225 m ²
Accommodation	23 persons

ANCHOR HANDLING CAPACITIES	
Towing AH winch - double drum waterfall	250 t
Tugger winch	2 x 10 t
Storage winch	1200 m - 76 mm

TANK CAPACITIES	
Water Ballast	220 m ³
Fresh Water	565 m ³
Lub. Oil	24 m ³
MDO	600 m ³

MACHINERY / PROPULSION / DECK EQUIP.	
Main engines - Diesel Wartsila 8L32	2 x 4000 kW at 750 rpm
Shaft Generators - Marelli	2 x 1000 kVA at 1800 rpm 440 V - 60Hz
Diesel Generators - Marelli	2 x 265 kW/313 kVA at 1800 rpm - 440 V - 60Hz
Harbour/Emergency Generator - Marelli	1 x 122/134 kVA at 1800 rpm - 440 V - 60Hz
Bow thrusters - Schottel	2 x 350 kW electrical drive type FP
Propellers	2 x CP - dia. 3300 mm
Rudders	2 X High lift flap
Fire-Fighting system	Fi-Fi 2
Dynamic Positioning	DP2
Deck Crane	Electro-hydraulic SWL 2.6 t at 12.35 m

CARGO DISCHARGE PUMPS	
2 off Fuel oil	35 m ³ /h at 50 m head
1 off Fresh water	100 m ³ /h at 60 m head
1 off Drill water	100 m ³ /h at 60 m head

PERFORMANCES	
Bollard pull	142.5 t
Max speed/consumption	14.2 knots at 28 m/t



Rosetti Marino Headquarters
Via Trieste, 230 - 48122 Ravenna - Italy
tel. +39 0544 878 111 - fax +39 0544 878 188
e-mail: rosetti@rosetti.it - www.rosetti.it



ROSETTI MARINO
Group of Companies

AHTS

MULTIFUNCTIONAL ANCHOR HANDLING TUG, SUPPLY AND SERVICE VESSEL - UT 712 CD

Name of Vessel

C107 - ASSO TRENTUNO (delivered 2012)

Type of Vessel

Multifunctional Anchor Handling Tug, Supply Vessel

Class notation

R.I.Na: C~~x~~ AUT-UMS; TUG, SUPPLY VESSEL, GREEN STAR 3 DESIGN, DYNA POS AM-R, COMF NOISE C, COMF VIB C, FIRE FIGHTING SHIP II, RESCUE, S.BY, OIL RECOVERY SHIP IP<60°C, INWATER SURVEY, UNRESTRICTED NAVIGATION, LOC DNV FOR CLEAN DESIGN, OIL RECOVERY, COMF (V3)

Design

ROLLS-ROYCE MARINE

Builder

ROSETTI MARINO S.p.A.

Owner and operator

AUGUSTA OFFSHORE S.p.A.



AHTS | UT 712 CD

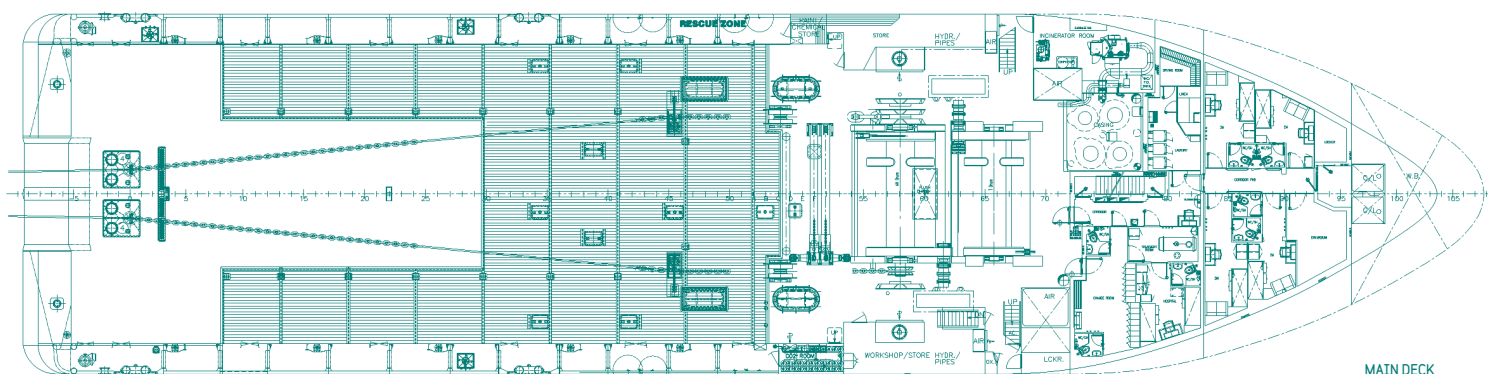

MAIN DECK

MAIN PARTICULARS

Length overall	79.90 m
Breadth, moulded	19.20 m
Length between perpendiculars	69.50 m
Design draught (2.0 m freeboard)	6.30 m
Depth	8.30 m
Dead weight at max. draught	2800 t
Gross tonnage	3740 GT
Deck Cargo / Deck area	1200 t / 610 m ²
Accommodation	35 persons

MACHINERY / PROPULSION

Main engines - Bergen B32:40L8	2 x 4000 kW at 750 rpm
Bergen B32:40L6	2 x 3000 kW at 750 rpm
Shaft Generators - Marelli	2 x 3000 kVA at 1200 rpm - 440V - 60Hz
Diesel Generators Man/Leroy Somer	2 x 515 kW/562,5 kVA at 1800 rpm - 440V - 60Hz
Emergency Generator Man/Leroy Somer	1 x 515 kW/530 kVA at 1800 rpm - 440V - 60Hz
CP Thrusters, 2 fwd Rolls-Royce TT 2200-DPN	each 883 kW
CP Thrusters, 2 aft Rolls-Royce TT 2000-DPN	each 883 kW
Propellers	2 x CP - dia. 4200 mm in nozzle
Rudders - Rolls-Royce	2 X High lift flap
Fire-Fighting system	Fi-Fi 2
Dynamic Positioning	DP2
Service Crane	SWL 5.1 t at 18 m

CARGO DISCHARGE PUMPS

WB/DW e/pump - 2 speed	2 off - 218 m ³ /h - 9 bar
Fuel oil/ORO e/pump - freq. controlled	1 off - 200 m ³ /h - 9 bar
Fresh water e/pump - freq. controlled	1 off - 200 m ³ /h - 9 bar
Liquid mud/ORO e/pumps - freq. controlled	1 off - 75 m ³ /h - 18 bar
Brine e/pump - freq. controlled	1 off - 75 m ³ /h - 18 bar
Base oil/fuel oil e/pump - freq. controlled	1 off - 100 m ³ /h - 9 bar

ANCHOR / TOWING WINCH / DECK EQUIP.

2 tugger winches - Rolls-Royce	24 t
2 secondary winches - Rolls-Royce	138 t
Capacity each secondary winch	1600 m of rope dia. 208 mm
1 towing /AH winch Rolls-Royce waterfall type:	
1 towing/working drum, 400 t dynamic pull	4930 m of dia. 76 mm, static brake 550 t
1 anchor handling drum, 500 t dynamic pull	6400 m of dia. 76 mm, static brake 625 t
1 Rolls-Royce Storage Reel Winch	1400 m of dia. 81 mm wire
2 Rail Cranes - Rolls-Royce	2 x SDO moveable hydraulic SWL 3t at 14.3 m

TANK CAPACITIES

Fuel Oil (incl. combination tanks)	1620 m ³
Water Ballast	2185 m ³
Drill Water	1170 m ³
Fresh Water	745 m ³
Base Oil	486 m ³
Dry Bulk cargo tanks (cement/barite)	235 m ³
Liquid Mud (s.g. 2.5)	730 m ³
Brine (s.g. 2.5)	485 m ³
ORO	1020 m ³

BOILERS, STEAM & GAS GENERATORS

MGO fired heater	250,000 Kcal/h
------------------	----------------

PERFORMANCES

Bollard pull	220 t
Max speed/consumption	17 knots / 65 t
Economical speed/consumption	11 knots / 17 t



Rosetti Marino Headquarters
Via Trieste, 230 - 48122 Ravenna - Italy
tel. +39 0544 878 111 - fax +39 0544 878 188
e-mail: rosetti@rosetti.it - www.rosetti.it



ROSETTI MARINO
Group of Companies

AHTS

MULTIFUNCTIONAL ANCHOR HANDLING TUG, SUPPLY AND SERVICE VESSEL - UT 712 CD

Name of Vessel

C112 - A.H. VARAZZE (delivered November 2014)

Type of Vessel

Multifunctional Anchor Handling Tug, Supply Vessel

Class notation

R.I.Na: C \boxtimes AUT-UMS; TUG, SUPPLY VESSEL, GREEN STAR 3 DESIGN, DYNA POS AM-R, COMF NOISE C, COMF VIB B, FIRE FIGHTING SHIP II, RESCUE, S.BY, OIL RECOVERY SHIP IP<60°C, INWATER SURVEY, UNRESTRICTED NAVIGATION, MON-SHAFT, ANCHOR HANDLING STAB

Design

ROLLS-ROYCE MARINE

Builder

ROSETTI MARINO S.p.A.

Owner and operator

FINARGE - ARMAMENTO GENOVESE SRL



AHTS | UT 712 CD

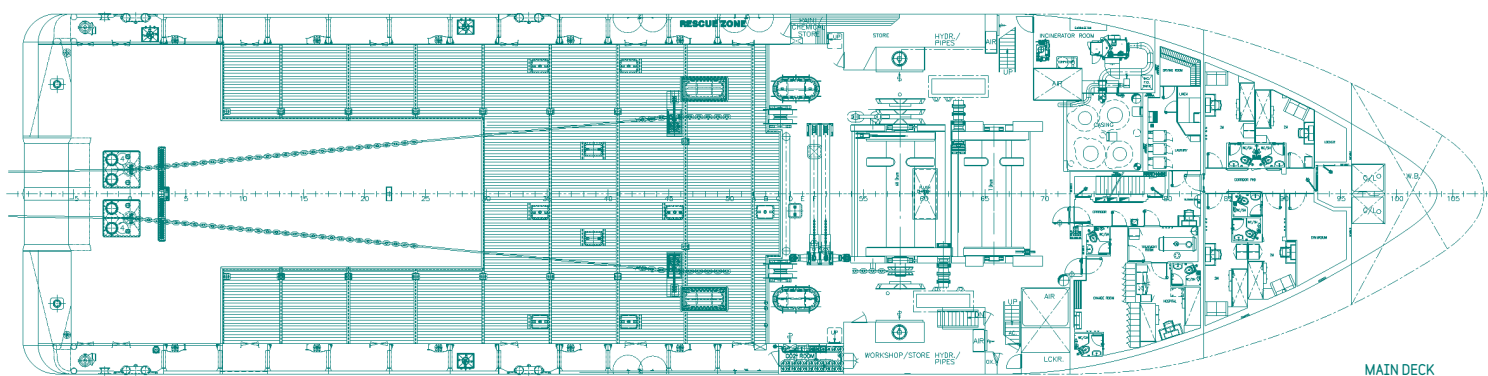

MAIN DECK

MAIN PARTICULARS

Length overall	79.90 m
Breadth, moulded	19.20 m
Length between perpendiculars	69.50 m
Design draught (2.0 m freeboard)	6.30 m
Depth	8.30 m
Dead weight at max. draught	2800 t
Gross tonnage	3740 GT
Deck Cargo / Deck area	1200 t / 610 m ²
Accommodation	35 persons

MACHINERY / PROPULSION

Main engines - Bergen B32:40L8	2 x 4000 kW at 750 rpm
Bergen B32:40L6	2 x 3000 kW at 750 rpm
Shaft Generators - Marelli	2 x 3000 kVA at 1200 rpm - 440V - 60Hz
Diesel Generators Man/Leroy Somer	2 x 515 kW/562,5 kVA at 1800 rpm - 440V - 60Hz
Emergency Generator Man/Leroy Somer	1 x 515 kW/530 kVA at 1800 rpm - 440V - 60Hz
CP Thrusters, 2 fwd Rolls-Royce TT 2200-DPN	each 883 kW
CP Thrusters, 2 aft Rolls-Royce TT 2000-DPN	each 883 kW
Propellers	2 x CP - dia. 4200 mm in nozzle
Rudders - Rolls-Royce	2 X High lift flap
Fire-Fighting system	Fi-Fi 2
Dynamic Positioning	DP2
Service Crane	SWL 5.1 t at 18 m

CARGO DISCHARGE PUMPS

WB/DW e/pump - 2 speed	2 off - 218 m ³ /h - 9 bar
Fuel oil/ORO e/pump - freq. controlled	1 off - 200 m ³ /h - 9 bar
Fresh water e/pump - freq. controlled	1 off - 200 m ³ /h - 9 bar
Liquid mud/ORO e/pumps - freq. controlled	1 off - 75 m ³ /h - 18 bar
Brine e/pump - freq. controlled	1 off - 75 m ³ /h - 18 bar
Base oil/fuel oil e/pump - freq. controlled	1 off - 100 m ³ /h - 9 bar

ANCHOR / TOWING WINCH / DECK EQUIP.

2 tugger winches - Rolls-Royce	24 t
2 secondary winches - Rolls-Royce	138 t
Capacity each secondary winch	1600 m of rope dia. 208 mm
1 towing /AH winch Rolls-Royce waterfall type:	
1 towing/working drum, 400 t dynamic pull	4930 m of dia. 76 mm, static brake 550 t
1 anchor handling drum, 500 t dynamic pull	6400 m of dia. 76 mm, static brake 625 t
1 Rolls-Royce Storage Reel Winch	1400 m of dia. 81 mm wire
2 Rail Cranes - Rolls-Royce	2 x SDO moveable hydraulic SWL 3t at 14.3 m

TANK CAPACITIES

Fuel Oil (incl. combination tanks)	1620 m ³
Water Ballast	2185 m ³
Drill Water	1170 m ³
Fresh Water	745 m ³
Base Oil	486 m ³
Dry Bulk cargo tanks (cement/barite)	235 m ³
Liquid Mud (s.g. 2.5)	730 m ³
Brine (s.g. 2.5)	485 m ³
ORO	1020 m ³

BOILERS, STEAM & GAS GENERATORS

MGO fired heater	250,000 Kcal/h
------------------	----------------

PERFORMANCES

Bollard pull	220 t
Max speed/consumption	17 knots / 65 t
Economical speed/consumption	11 knots / 17 t



Rosetti Marino Headquarters
 Via Trieste, 230 - 48122 Ravenna - Italy
 tel. +39 0544 878 111 - fax +39 0544 878 188
 e-mail: rosetti@rosetti.it - www.rosetti.it